

BEARINGS

KP SERIES—AN200 / MS27640

Single row, ball, heavy duty. PTFE seals and CRES sealcaps. Exposed surfaces except bore, caps, and seals are cadmium plated. Pre-lubricated for life. Also offered with CRES 440C material and/or zinc nickel plating per OEM specifications

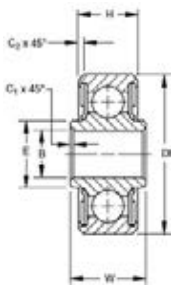

FAFNIR AND MS AFBMA Bearing No.	Bore 27640	Dia +.0000 - .0005 (in.)	Outside Inner Ring +.0000 - .0005 (in.)	Width Outer Ring +.000 - .005 (in.)	Width Inner Ring +.000 - .005 (in.)	Shoulder Width Bore Ring (Approx.) (in.)	Corner Chamfer x 45°		Balls		Pure Moment Rating Inch	Moment Constant 1 Lbs.	Weight Lbs. Inch (Approx.)	Price Each
							Inner Ring O. D. +.015 - .000 (in.)	Outer Ring +.015 - .000 (in.)	No.	Size				
KP3L*	-3A	.1900	.6250	.245	.203	.280	.005	.010	10	5/32"	51.8	12.08	.01	---
KP3	-3	.1900	.7774	.297	.270	.331	.005	.022	12	5/32"	93.7	10.13	.03	---
	-4	.2500	.9014	.484	.335	.390	.005	.032	11	1/4"	130	8.84	.04	---
KP5	-5	.3125	1.2500	.558	.375	.469	.015	.032	9	5/16"	335	6.77	.09	---
KP6	-6	.3750	1.4375	.620	.469	.591	.015	.032	10	11/32"	580	5.44	.15	---
KP8	-8	.5000	1.6875	.620	.500	.768	.015	.044	10	11/32"	1060	4.46	.21	---

* Stainless steel shield (for "Ply-Seals" use KP3A which has same bore and O.D.) Equiv. Thrust Load = Thrust + .8 Radial Load + Moment Constant x Moment in Inch Lbs.

KP-A SERIES—AN201 / MS27641

Single row, ball, deep groove, medium duty. PTFE seals and CRES sealcaps. Exposed surfaces except bore, caps, and seals are cadmium plated. Pre-lubricated for life. Also offered with CRES 440C material and/or zinc nickel plating per OEM specifications

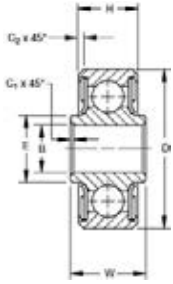

FAFNIR AND MS AFBMA Bearing No.	Bore 27641	Dia +.0000 - .0005 (in.)	Outside Inner Ring +.0000 - .0005 (in.)	Width Outer Ring +.000 - .005 (in.)	Width Inner Ring +.000 - .005 (in.)	Shoulder Dia. Bore Ring (Approx.) (in.)	Corner Chamfer x 45°		Balls		Max Static Non-Brinell Rating		Pure Moment Rating Inch-Lbs.	Moment Constant 1 Inch	Weight Lbs. (Approx.)	Price Each
							Inner Ring O. D. +.015 - .000 (in.)	Outer Ring +.015 - .000 (in.)	No.	Size	Radial Lbs.	Thrust Lbs.				
KP3A	3	.1900	.6250	.297	.234	.297	.005	.016	10	1/8"	800	600	51.8	12.08	.01	---
KP4A	4	.2500	.7500	.281	.219	.380	.005	.016	12	1/8"	1100	900	73.8	10.17	.02	---
KP5A	5	.3125	.8125	.297	.234	.415	.015	.016	14	1/8"	1300	1000	100	8.76	.02	---
KP6A	6	.3750	.8750	.313	.250	.495	.015	.016	16	1/8"	1400	1100	130	7.68	.03	---
KP8A	8	.5000	1.1250	.375	.313	.616	.015	.016	16	5/32"	2200	1700	250	6.14	.05	---



KS SERIES—MS27645

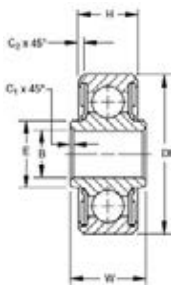

FAFNIR AND MS AFBMA Bearing No.	Bore 27645	Dia +.0000 - .0005 (in.)	Outside Inner Ring +.0000 - .0005 (in.)	Width Outer Ring +.000 - .005 (in.)	Width Inner Ring +.000 - .005 (in.)	Shoulder Width Bore Ring (Approx.) (in.)	Corner Chamfer x 45°		F (Approx.)	Balls		Maximum Static Rating		Weight Lbs. (Approx.)	Price Each
							Inner Ring O. D. +.015 - .000 (in.)	Outer Ring +.015 - .000 (in.)		No.	Size	Radial Lbs.	Thrust Lbs.		
KSP3L	3A	.1900	.6250	.245	.203	.257	.005	.016	---	13	3/32"	400	100	.01	---
KSP3	3	.1900	.7774	.297	.270	.342	.005	.022	.275	12	1/8"	800	200	.03	---
KSP4	4	.2500	.9014	.484	.335	.400	.005	.032	.408	12	5/32"	1100	300	.04	---
KSP5	5	.3125	1.2500	.558	.375	.562	.015	.032	.408	13	3/16"	1400	300	.10	---
KP6	6	.3750	1.438	.62	.469	.591	.015	.032	---	10	11/32"	2980	400	.15	---
*KS6A	6A	.3750	.8750	.313	.250	.475	.016	.016	.277	15	1/8"	1000	200	.03	---

* NOTE: These bearings are self-aligning for 10° in either direction except for KS6A (not AN200) which is self-aligning for 8° in either direction.

DP SERIES—AN207 / MS27644

Double row, ball, light and heavy duty. PTFE seals and CRES sealcaps. Exposed surfaces except bore, caps and seals are cadmium plated. Pre-lubricated for life. For use where high moment rigidity is required, DPP-W series only. Also offered with CRES 440C material and/or zinc nickel plating per OEM specifications

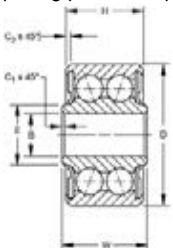

FAFNIR Bearing No.	MS 27644	Bore +.0000 - .0005 (in.)	Dia. +.0000 - .005 (in.)	Outside Inner Ring +.000 - .005 (in.)	Width Outer Ring +.000 - .005 (in.)	Shoulder Width Inner Ring (Approx.) (in.)	Corner Chamfer x 45°		Balls		Maximum Static Non-Brinell		Weight Lbs. (Approx.)	Price Each
							Dia. Bore +.015 - .000 (in.)	Inner Ring O. D. +.015 - .000 (in.)	No.	Size	Radial Lbs.	Thrust Lbs.		
DPP3	-3	.1900	.7774	.495	.473	.302	.005	.02	20	5/32"	2500	1700	.04	---
DPP4	-4	.2500	.9014	.620	.491	.410	.005	.032	22	5/32"	3000	1800	.06	---
DPP5	-5	.3125	1.2500	.745	.687	.469	.015	.032	20	1/4"	6900	4200	.17	---

DSP SERIES—AN206 / MS27643

Double row, ball, self-aligning, heavy duty. PTFE seals and CRES sealcaps. Exposed surfaces except bore, caps, and seals are cadmium plated. Pre-lubricated for life. Also offered with CRES 440C material and/or zinc nickel plating per OEM specifications

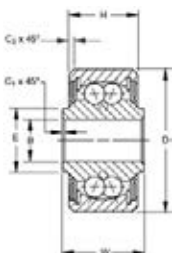

FAFNIR Bearing No.	MS 27643	Bore +.0000 - .0005 (in.)	Dia. +.0000 - .005 (in.)	Outside Inner Ring +.000 - .005 (in.)	Width Outer Ring +.000 - .005 (in.)	Shoulder Width Inner Ring (Approx.) (in.)	Corner Chamfer x 45°		Balls		Maximum Static Non-Brinell		Weight Lbs. (Approx.)	Price Each
							Dia. Bore +.015 - .000 In.	Inner Ring O. D. +.015 - .000 In.	No.	Size	Radial Lbs.	Thrust Lbs.		
DSP3	-3	.1900	.7774	.500	.392	.304	.005	.022	24	1/8"	1420	200	.04	---
DSP4	-4	.2500	.9014	.687	.464	.430	.005	.032	30	1/8"	1780	300	.06	---
DSP5	-5	.3125	1.2500	.812	.656	.515	.015	.032	28	3/16"	3740	600	.16	---